



Digital life made easy

Join-In for Communicator 5

Accessible SMS (Android Messages)



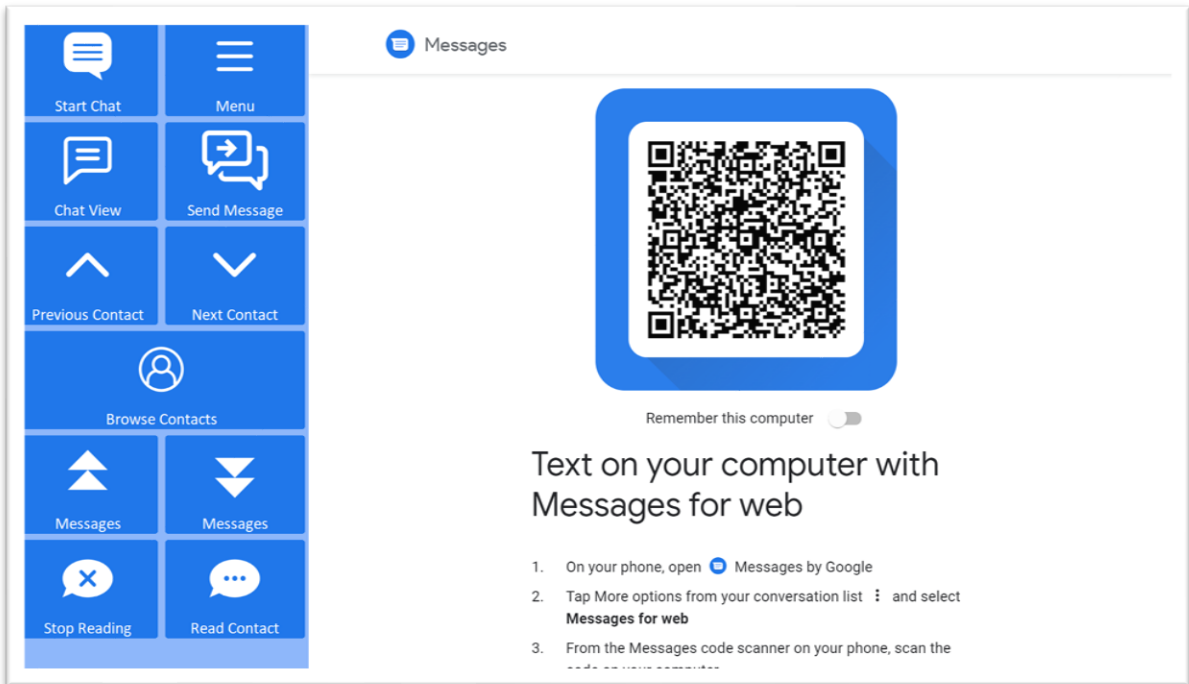

Getting Started

- Requirements – to use Accessible SMS you need the application Messages (SMS) by Google, installed on your Android Smartphone or tablet with cellular connectivity.
- Using Accessible SMS for the first time – After selecting **Accessible SMS** from your Home Page, you will see the “scan QR code” prompt. On your smartphone or tablet, go to Messages. Follow the instructions on your device screen (“Text on your computer with Messages for web”) for how to add a computer by scanning a QR code.
- You are now ready to use Accessible SMS.
- Note – Accessible SMS uses Messages for Web, which requires your phone or tablet to be connected to the internet.

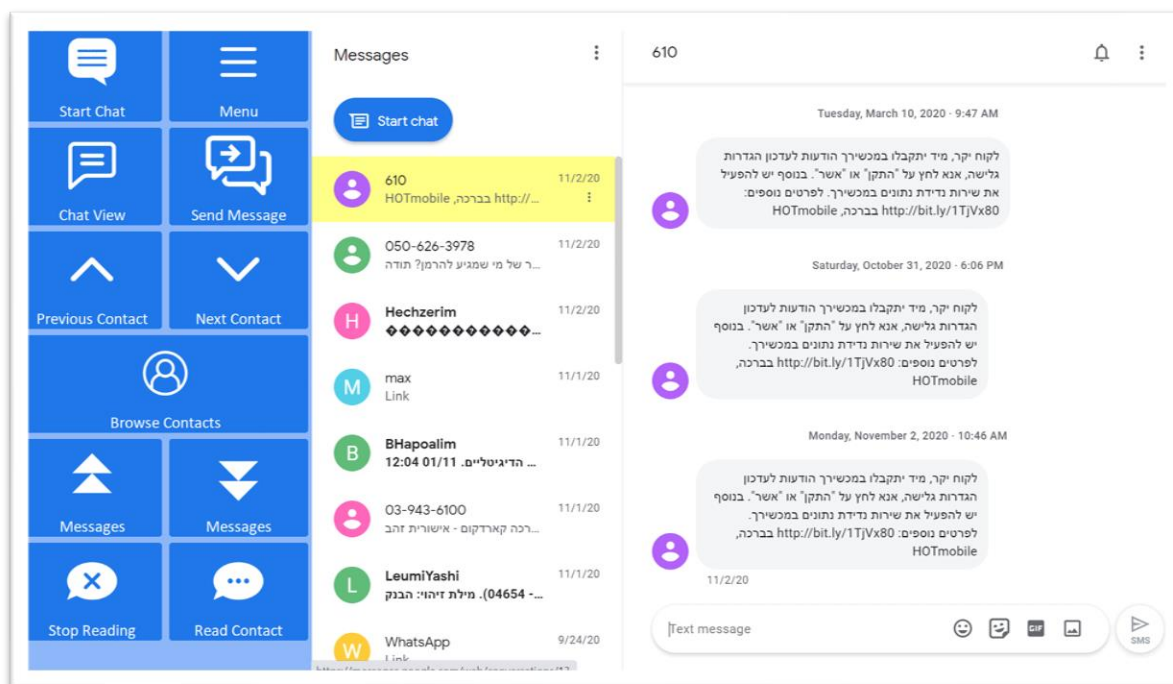

Home

- **Start Chat** – search for a contact to start a chat with.
- **Menu** – go to Accessible SMS Menu.
- **Previous Contact / Next Contact** – the yellow background highlight shows which one of your chats is currently selected. Use these buttons to navigate up and down in the chats panel on the left side of the browser window.
- **Messages Up / Down** – the right side of the browser window shows the message history for the currently selected chat. Use these buttons to scroll up and down.
- **Chat View** – the **Messages** buttons only allow you to scroll the message panel. Click **Chat View** to access more features and ways to interact with messages.
- **Send Message** – send a message (text, emoji, picture, file...) to the selected contact.
- **Browse Contacts** – open a popup table to find a contact you are looking for.
- **Read Contact** – read the name of the selected contact aloud.
- **Stop Reading** – stop reading aloud.

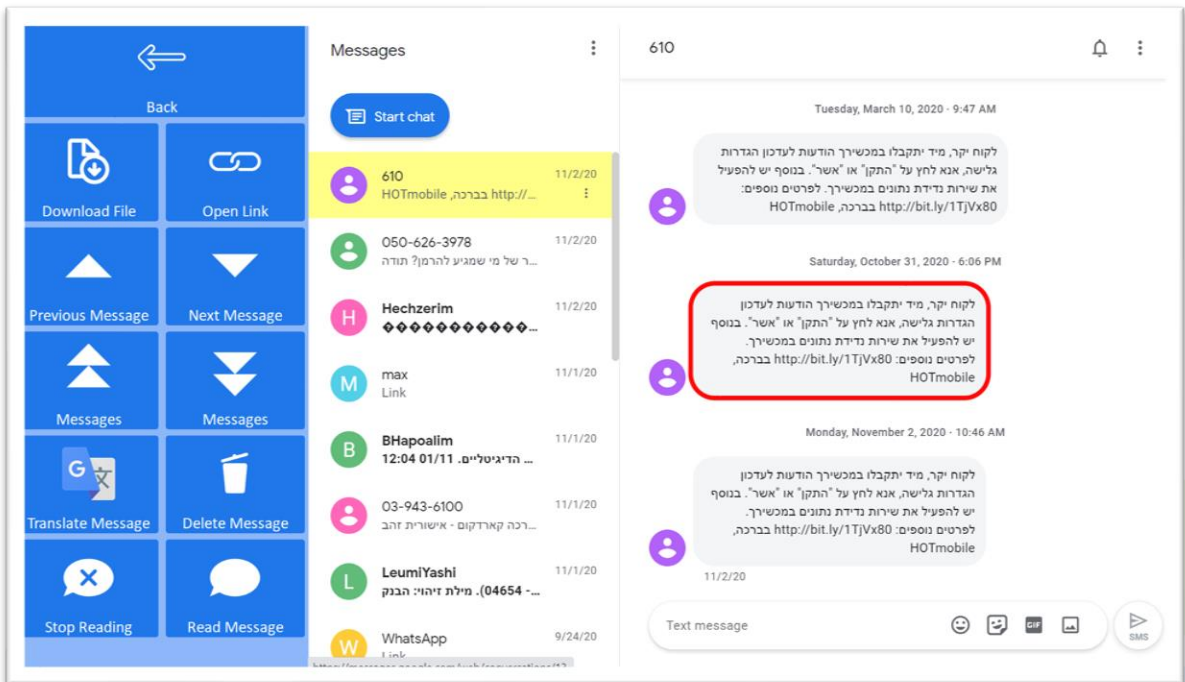

Chat View

- **Back** – leave chat view and return to **Home** view.
- **Previous / Next Message** – the red highlight border shows the currently selected message. Use these buttons to move up and down to other messages.
- **Messages** up and down – scroll several messages up or down.
- **Download File** – download file from the selected message to your computer.
- **Open Link** – Open a link from the selected message, in a new window.
- **Read Message** – read the selected message aloud.
- **Translate Message** – opens [Accessible Google Translate](#) to get a translation of the selected message.
- **Delete Message** – delete the currently selected message.

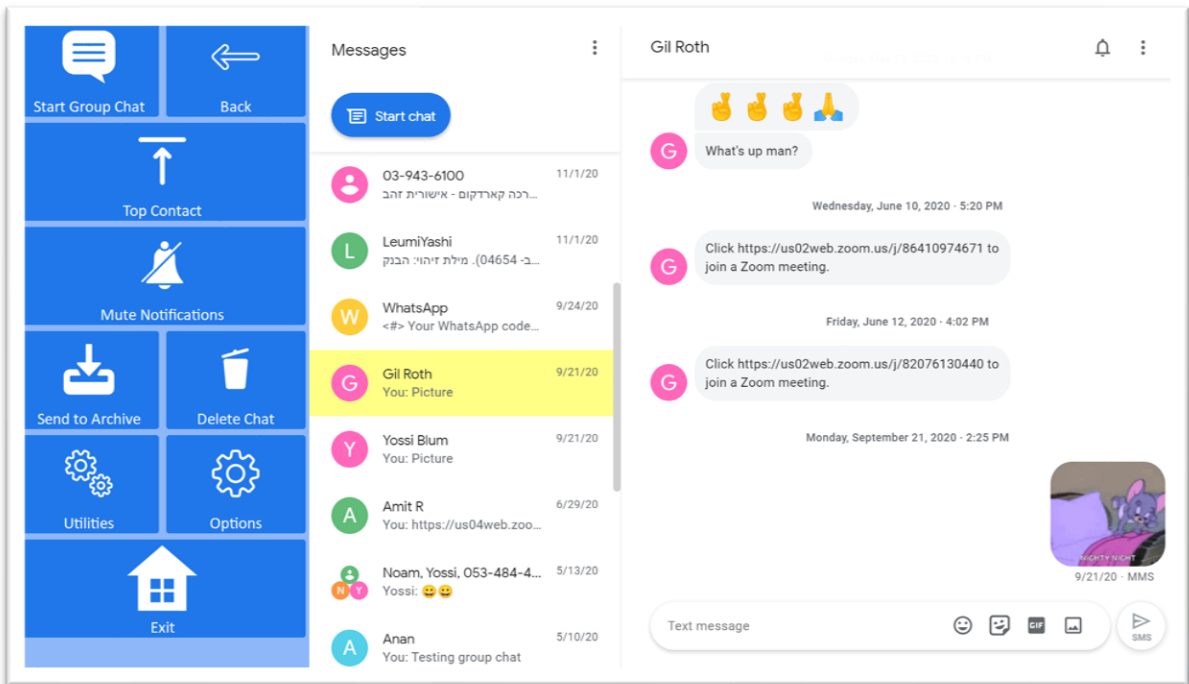

Menu

- **Start Group Chat** – select contacts for a group chat.
- **Top Contact** – go to the first contact.
- **Mute Notifications** – mute all notifications.
- **Send to Archive** – archive the selected chat.
- **Delete Chat** – delete the selected chat.
- **Options** – change the computer volume, toggle text enlargement and adjust text size, turn on Dark Mode, turn auto-read on and off, access the [Join-In Settings](#) app.
- **Utilities** – **Recover** or reopen Accessible SMS, **Block Touch** or **Allow Touch** access, close windows you do not need, close popup messages, zoom in or zoom out...



Browse Contacts

- Clicking **Browse Contacts** in opens a popup table to display all your chats, in order of how recently they have been active. You will be redirected to a menu toolbar to help you choose one based on your accessibility settings.
- The buttons you see depend on the **Selection Method** applied in the **Join-In Settings** app. Consult these training cards for full guidance on how to change your accessibility settings.